

### MINI LEVER ENTRANCE LOCK KITS IN 316SS

#### Product codes:

1364-SS | 1365-SS

#### Tools Required

- Drill
- Hammer
- 25mm spade drill bit
- 20mm spade drill bit
- 14mm spade drill bit
- 6mm drill bit
- 0# square-drive bit (Robertson drive bit)
- Pencil
- Chisel
- Pozi-drive bit
- Ruler
- Square

#### Parts for 1364-SS

- 1x Euro 85 Mortice Lock (including striker plate, cylinder screw and fixing screws)
- 1x Round Mini Lever Turn set (including 8mm spindle shaft and thru-fixing screws)
- 1x 70mm Euro Cylinder
- 1x Round Euro Escutcheon set (including fixing screws and allen key)

#### Parts for 1365-SS

- 1x Euro 85 Mortice Lock (including striker plate, cylinder screw and fixing screws)
- 1x Square Mini Lever Turn set (including 8mm spindle shaft and thru-fixing screws)
- 1x 70mm Euro Cylinder
- 1x Square Euro Escutcheon set (including fixing screws and allen key)

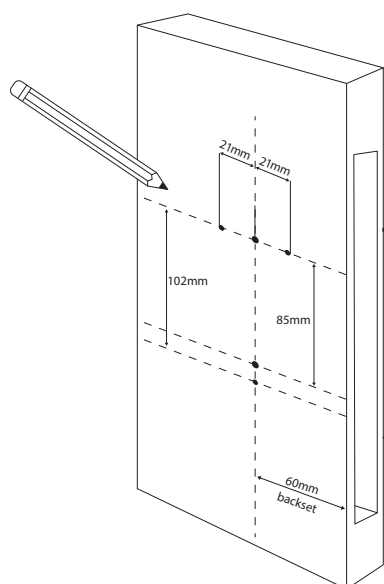

1. Check length and desired position of chosen pull handle and then mortice out door to fit lockcase.
2. 60mm back from the door edge backset mark one centre hole for the spindle. Then using the spindle mark as a starting point measure and mark 21mm to the left and the right for the thru-fixing screws.
3. Using the spindle mark as the starting point measure down vertically and mark at both 85mm and 102mm (ensure the marks are still 60mm back from the door edge).

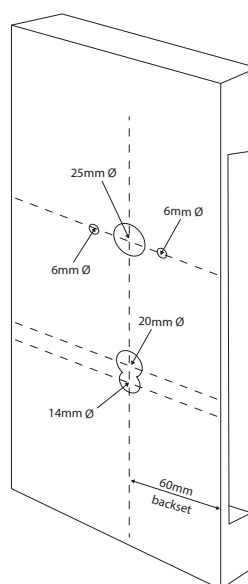

4. Drill a 25mm hole on the first mark for the spindle (see step 2) then drill 2x 6mm holes on the marks next to the spindle hole for the thru-fixing bolts.
5. Drill a 20mm hole down 85mm from the centre of the spindle (see step 3) then drill a 14mm hole at the 102mm mark.

Note these holes will overlap to allow for the Euro Cylinder to be inserted.

#### Note

For clean cut-outs, drill from both sides, meeting in the middle of the door and always keep the drill level.

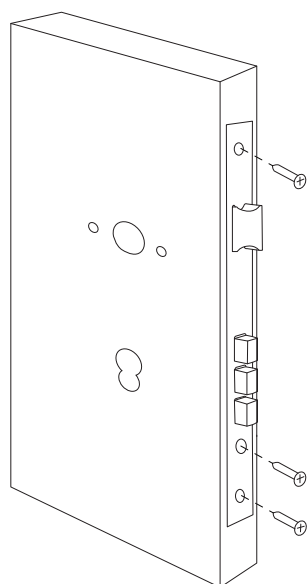

6. Check latch tongue is facing the correct way to latch on door frame, reverse if necessary by lifting up the tab behind the latch tongue, push latch tongue into lockcase and rotate 180° degrees then release the latch tongue and ensure tab is returned to the downward position.
7. Fit lockcase to door with screws provided, then insert euro cylinder through door and into lockcase and fasten with cylinder screw provided.

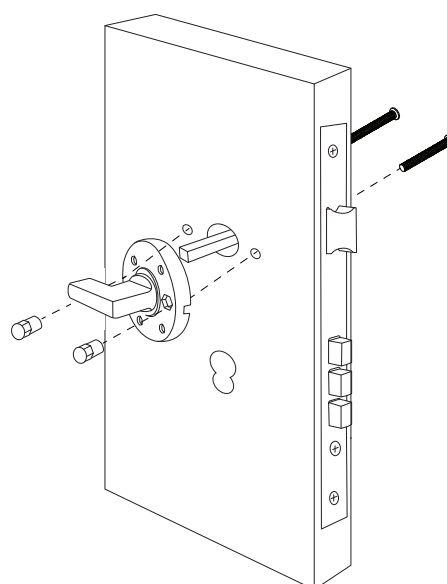

8. Insert spindle into lockcase, ensure an even length is protruding out each side of the door.
9. Fit turn plates to either side of the door over square spindle and fix with thru-fixing screws and the screws provided. Insert hex shaped blind screw cap into hex shaped screw holes in the rose at the 3 o'clock and 9 o'clock positions.

#### Note

The thru-fixing screws can be cut down using the snip increments depending on the door thickness.

### MINI LEVER ENTRANCE LOCK KITS IN 316SS

Product codes: 1364-SS | 1365-SS

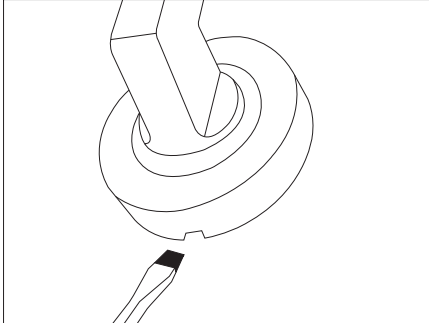

1. To remove the rose cover, use a flat head screwdriver, ideally the same width as the groove on the bottom of the rose.

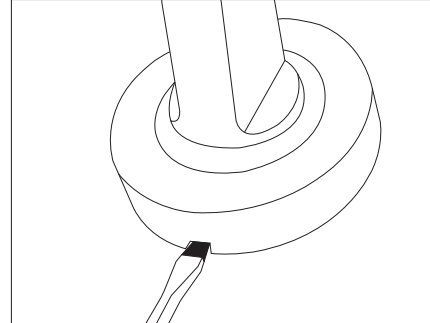

2. Insert the screwdriver into the groove on the side of the rose.

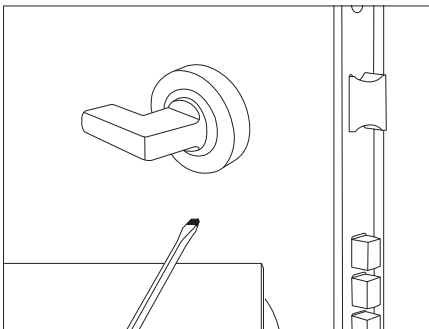

3. To protect the door and hardware from getting damaged, use a small piece of cardboard or something similar and use the screwdriver as a lever.

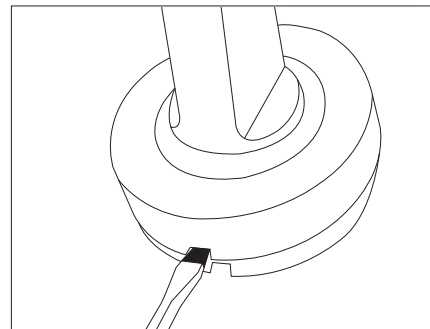

4. Lever the rose cover off the handle. The rose cover will pop off. Carefully slide the loose rose cover off the mini lever.

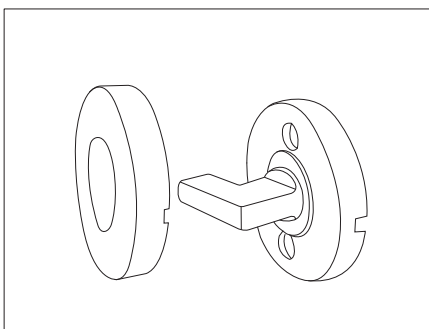

5. The screws can now be accessed and unscrewed.

**Note:** This removal method is the same for both the round rose kit (1183) and square rose kit (1184).

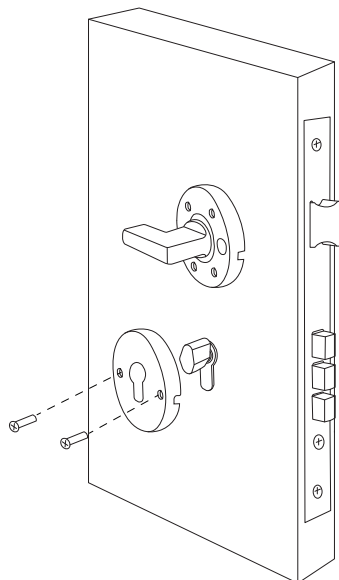
**MINI LEVER ENTRANCE LOCK KITS IN 316SS****Product codes:****1364-SS | 1365-SS**

- 10.** Fit Euro Escutcheon plates around Euro Cylinder and fix to door with screws provided.

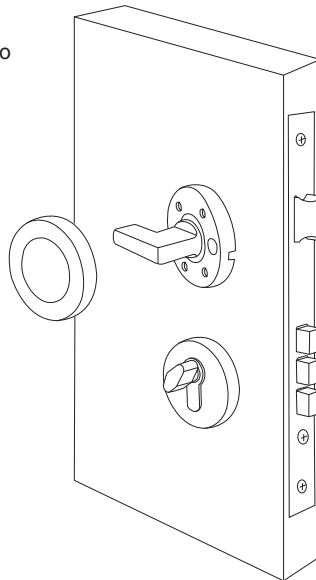

- 11.** Carefully slide the loose rose cover onto the mini lever. Clip on the cover plates to both turns and escutcheons.

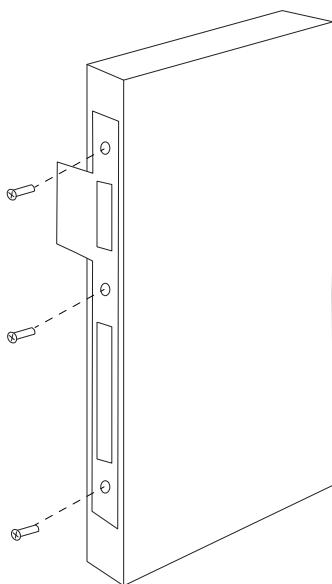

- 12.** Crop out door frame to fit strike plate and dustbox provided using the dustbox as a guide for depth, then insert dustbox behind strike plate and fix to door frame with screws provided.

Note: A strike packer will be required if fitting to door with aluminium frames. Use code: 1186 for 8mm frames and code: 1185 for 10mm frames.  
A rebate kit will be required when fitted to rebated doors. Use code: 1146.  
Extended striker plates also available to suit this lock kit. Code: 1234 (24mm tongue), 1187 cut to length up to 75mm.